

# 104-1811CLDNA(B)

P4 Serial SBC with Atom™ N270/Intel®945GSEVGA/LVDS/LAN

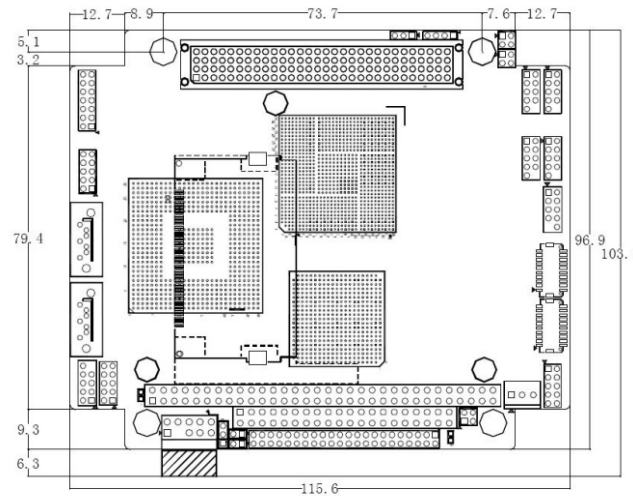
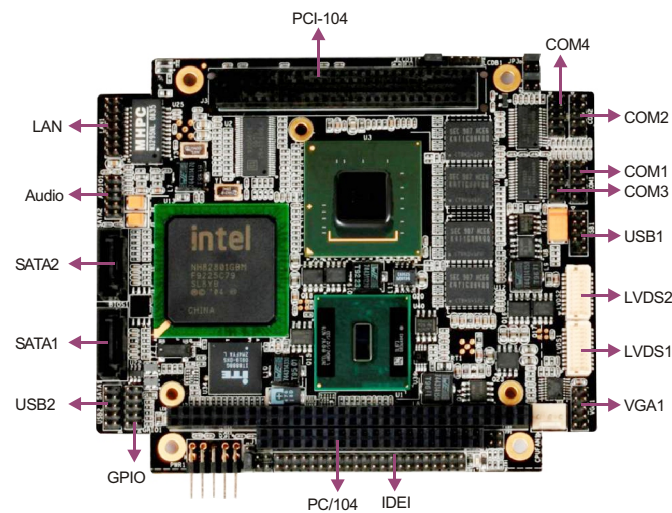

## FEATURES

- Onboard Intel®ATOM™ N270 1.6G /512K/533MHz Processor
- onboard 1G DDR2
- Supports 1 x 10/100/1000Mbps Ethernet interface
- Supports VGA,24-bit dual-channel LVDS display
- Supports 4 x USB2.0, 4 x COM(two of them support optional RS-422/485), 2 x SATA2, 1 x IDE 1 x PC/104 Plus

## SPECIFICATIONS

| System              |  |
|---------------------|--|
| Processor           | Onboard Intel®ATOM™ N270 1.6G /512K/533MHz Processor               |
| Chipset             | Intel® 945GSE+ ICH7M   |
| Memory              | Onboard memory supports 1GB DDR2                                   |
| Hardware Monitor    | Monitors system status, voltage, temperature                       |
| Watchdog Timer      | 1~255 sec./min. timer system reset or interrupt, setup by software |
| Expansion Interface | PC/104-Plus  |
| Storage             |  |
| IDE                 | 1 x 44pin Ultra ATA 66/100 IDE interface                           |
| Serial ATA          | 2 x Serial ATA 300MB/s interface                                   |
| Floppy              | N/A  |
| CF                  | 1 x CompactFlash Socket Type I/II                                  |
| DOC/DOM             | N/A  |
| I/O Interface       |  |
| USB                 | 4 x USB2.0 Ports, available interface of 5 x 9-pin header onboard  |
| Serial Port         | 4 x COM(two of them support optional RS-422/485)                   |
| Parallel Port       | N/A  |
| IrDA                | N/A  |
| GPIO                | 4channel digital input and 4channel digital output                 |
| Audio               | AC' 97, supporting Mic-in/Line-in/Speaker-out                      |
| Keyboard/Mouse      | N/A  |

| Display                      |   |
|------------------------------|---|
| Chipset                      | Intel®945GSE integrated graphics controller                                       |
| Memory                       | 128MB shared memory   |
| Resolution                   | Onboard VGA port (onboard pin), onboard LVDS port, supporting 1280x800 resolution |
| Dual Display                 | Supports VGA and LVDS display mode; VGA+ LVDS dual display                        |
| Ethernet                     |   |
| Chipset                      | 1 x RTL8111D Ethernet controller  |
| Speed                        | 10/100/1000Mbps   |
| Connector                    | 1 x RJ45  |
| Mechanical and Environmental |   |
| Dimensions                   | 115.6mm(1) x 103.1(w) x 23.22(H)  |
| Operating Temperature        | -20℃~70℃  |
| Storage Temperature          | -40℃ - 85℃  |
| Operating Humidity           | 5%-90%, non-condensing  |
| Power                        |   |
| Power Supply                 | Single 5V power supply  |
| Power consumption            | 12W   |
| Operating System             |   |
| Windows OS                   | Windows 2000/Windows XP   |
| Embedded OS                  | Linux/XP Embedded/WinCE/ VXWORKS  |

## Board Diagram

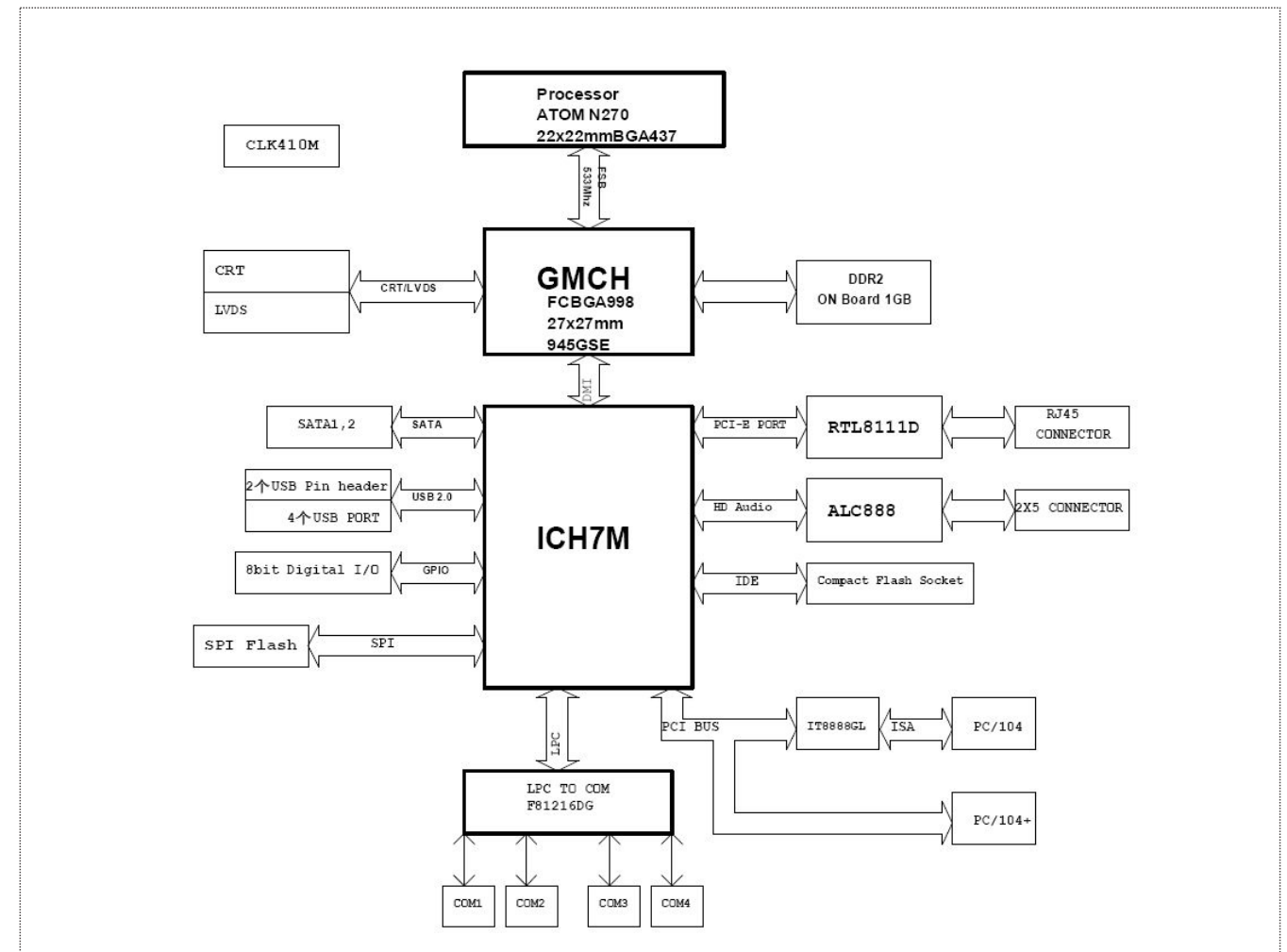

## Available Accessories

| Part Number | Name   | Description   | Qty |
|-------------|--|---|-----|
| 2360-024341 | RJ45 cable/RoHS                                    | DB 2x7-pin (2.0mm) female connector to RJ45/UL20276/28AWG/14-pin, length=300mm                  | 1   |
| 2360-024351 | Converter cable/RoHS                               | DB 2x2-pin (2.0mm) female connector to buzzer reset button/UL2464/28AWG/length: 300mm           | 1   |
| 2360-014781 | USB cable/RoHS                                     | DB 2x5-pin (2.0mm) to USB plastic connector with bracket/length: 550mm/A1                       | 2   |
| 2360-012651 | DC power cable/RoHS                                | 2x5-pin female connector to big 4-pin power supply male connector (5.08mm), length=250mm        | 1   |
| 2360-008781 | Flat cable/RoHS                                    | 40-pin connector to 44-pin connector P(2.0mm), length: 550mm                                    | 1   |
| 2360-027521 | COM cable/RoHS                                     | DB 9-pin male connector to DB 2x5-pin female connector, 2.0mm, length: 300mm                    | 4   |
| 2360-012641 | VGA cable/RoHS                                     | DB 2x5-pin female connector (2.0mm) to type D right angle 15-pin female connector, length=300mm | 1   |
| 2360-017961 | SATAHDD cable/RoHS                                 | SATA-7-pin female elbow connector/with spring strip/length: 550mm                               | 2   |
| 2360-002581 | AV cable/RoHS                                      | DB 2x5-pin female connector (2.0mm) to 3 x audio port with bracket/length: 300mm                | 1   |
| 2330-000011 | Jumper/SHINNING/RoHS                               | 2.0mm pitch black, sealed tail  | 4   |
| 2192-009591 | Driver CD/Protective film/Chinese and English/RoHS | 104-1811CLDNA(B)/VER:A1   | 1   |
| 2412-001351 | Fast installation guide/Chinese and English/RoHS   | 104-1811CLDNA(B)/VER:A1   | 1   |

## Ordering information

| Part Number | Model Number     | Description |
|-------------|------------------|-------------|
| 0030-014270 | 104-1811CLDNA(B) | Motherboard |
| 0030-014271 | 104-1811CLDNA(B) | Motherboard |