

# PCI-18SQ-RS-R40

## 18-Slot Backplane with 12 PCI and 2 ISA Bus User Manual Ver. 4.0

### 1. PW1, PW3, PW5, PW7: ATX Power Connector

Pin	Description	Pin	Description
1	+3.3Vdc	11	+3.3Vdc
2	+3.3Vdc	12	-12Vdc
3	GND	13	GND
4	+5Vdc	14	PS-ON
5	GND	15	GND
6	+5Vdc	16	GND
7	GND	17	GND
8	PWR-OK	18	-5Vdc
9	+5VSB	19	+5Vdc
10	+12Vdc	20	+5Vdc

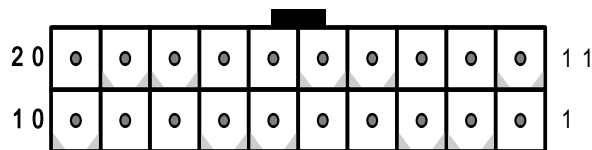

### 3. CN2, CN4, CN6, CN8: Backplane to Mainboard ATX power control connector

Pin	Description
1	GND
2	PSON#
3	5VSB



3 2 1

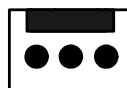

3 2 1

**6. PCI routing table:  
System 1.**

PCI Routing					
Sginal	REQ#	GNT#	CLOCK	IDSEL	INT
PCI 3	REQ#1	GNT#1	CLK1	AD30	C, D, A, B
PCI 4	REQ#2	GNT#2	CLK2	AD29	D, A, B, C
PCI 5	REQ#3	GNT#3	CLK3	AD28	A, B, C, D

**System 2.**

PCI Routing					
Sginal	REQ#	GNT#	CLOCK	IDSEL	INT
PCI 7	2_REQ#1	2_GNT#1	2_CLK1	2_AD30	C, D, A, B
PCI 8	2_REQ#2	2_GNT#2	2_CLK2	2_AD29	D, A, B, C
PCI 9	2_REQ#3	2_GNT#3	2_CLK3	2_AD28	A, B, C, D

**System 3.**

PCI Routing					
Sginal	REQ#	GNT#	CLOCK	IDSEL	INT
PCI 12	3_REQ#1	3_GNT#1	3_CLK1	3_AD30	C, D, A, B
PCI 13	3_REQ#2	3_GNT#2	3_CLK2	3_AD29	D, A, B, C
PCI 14	3_REQ#3	3_GNT#3	3_CLK3	3_AD28	A, B, C, D

**System 4.**

PCI Routing					
Sginal	REQ#	GNT#	CLOCK	IDSEL	INT
PCI 16	4_REQ#1	4_GNT#1	4_CLK1	4_AD30	C, D, A, B
PCI 17	4_REQ#2	4_GNT#2	4_CLK2	4_AD29	D, A, B, C
PCI 18	4_REQ#3	4_GNT#3	4_CLK3	4_AD28	A, B, C, D

**7. Notice:**

- a. Recommend to use 6mm width spacer to install

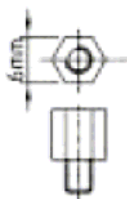

- b. Torsion must less than 6lb-inch

### 8. Dimension:

