

FWA-6500

Multi-Core x86 Intel® Xeon® Processor 5500 series based 2U Network Application Platform

NEW



Features

- Supports 2 x Intel® Xeon® Processor 5500 series with 4/8MB L2 cache and QPI @ 5.86/4.8 GTs
- Supports Dual-Core/Quad-Core Intel® Xeon® E5540/E5504 Nehalem-EP processors
- Supports DDR3 800/1066 1066 registered ECC memory, up to 48 GB
- Supports 4 x NIC modules, 4-port copper/fiber to 2-port 10GE modules
- Supports 2 segment LAN bypass for each 4-port Copper module
- Supports 2 x PCI-E full-height/ half-length add-on cards
- Supports 2 x 2.5" removable SATA HDD (3.5" removable SATA HDD for option)



Introduction

Built on functionality and capability, the FWA-6500 system provides the high performance and feature set required for a dual processor-based high-end network communication appliance with configuration options optimized for intensive computing, high energy-efficiency and high speed I/O bandwidth. The single or dual Intel® Xeon Dual/Quad-Core Nehalem-EP processors are based on the Intel QuickPath Interconnect architecture and VT technology, designed to improve performance in a virtual environment. The chipset consists of the Intel® 5520 Tylersburg I/O Hub (IOH), Intel® I/O Controller Hub (ICH10R) and the I/O subsystem.

The FWA-6500 is optimized for space constrained installations. It supports Quad-Core and Dual-Core Xeon processors, DDR3 800/1066 Registered ECC memory with the memory controller embedded in the Nehalem-EP processor. The Intel 5520 IOH provides 36 PCI-E Gen2 Lanes and the ICH10R provides 6 x PCI-E Gen1 lanes. Therefore, the FWA-6500 can provide flexible and different combinations of Ethernet modules such as 4-port RJ-45/SFP GE NIC modules, 2-port SFP+ 10G NIC modules and 8-port RJ-45/SFP GE NIC modules.

In addition, the FWA-6500 supports two 2.5" SATA hard disk drives and still has space to support 2 PCI-E add-on cards in front for external access. The FWA-6500 is also capable of supporting two 3.5" SATA hard disk drives with the use of a riser card. The front panel also has an RJ-45 type serial port, two 10/100/1000 Mbps managed LAN ports, two USB ports and an LCD module for local system management, maintenance, and diagnostics. FWA-6500 is FCC, UL, CE, CCC and RoHS compliant.

Specifications

| | | | |
|-------------|-----------------------|---|---------------------------|
| Processor | CPU | 2 x Intel Xeon Dual/Quad-Core processors | |
| | Max. Speed | Intel Xeon E5540 Quad Core 2.53 GHz with 5.86 GT/s QPI and Intel Xeon E5504 Quad Core 2.00 GHz with 4.8 GT/s QPI | |
| | L2 Cache | 4 MB/8 MB | |
| Memory | Technology | DDR3 800/1066 MHz ECC registered memory | |
| | Capacity | Up to 48 GB with 12 DIMM 4G dual rank memory module | |
| PCI-express | Chipset | Intel 5520 (Tylersburg-EP) + Intel ICH10R | |
| | Expansion Slot | 4 x PCI-E x8 slots connect to NIC module 2 x PCI-E x4 slots for riser card 1 x PCI-E x4 slot for management board | |
| | Riser Card | 2 x PCI-E x4 riser cards Supports full-height/half-length cards and external access | |
| | Management Port | 2 x Intel 82574E 10/100/1000 Base-T Ethernet | |
| Ethernet | NIC Module | 4 x NIC modules | |
| | Gigabit Ethernet | Copper module included 4 x Gigabit Ethernet ports with Intel 82576 Ethernet controller by RJ-45 interface Fiber module included 4 x Gigabit Ethernet ports with Intel 82576 Ethernet controller by SFP interface | |
| | LAN Bypass | Up to 8 segments on the copper option | |
| | 10GE Module | Intel 82599ES 10GE controller Support 2 port 10GE by SFP+ interface | |
| Storage | SATA | 2 x 2.5" Hot-swappable SATA hard drive in the front 2 x 3.5" Hot-swappable SATA hard drive in the front (Option) | |
| | Compact Flash | 1 x CF Socket | |
| Peripheral | USB | 2 x USB 2.0 ports in the front | |
| | Serial | 1 x console port by RJ-45 connector in the front | |
| | LCD Module | 1 | |
| Power | Watt | 600W 2U (1+1 redundant, 600W each) | |
| | Input | AC 100 ~ 240 V @ 50 ~ 60 Hz, full range | |
| Environment | Operating | Non-Operating | |
| | Temperature | 0 ~ 40° C (32 ~ 104° F) | -20 ~ 75° C (-4 ~ 167° F) |
| | Humidity | 5 ~ 85% @ 40° C (104° F) | 5 ~ 95% |
| Physical | Dimension (W x H x D) | 430 x 80 x 547.6 mm | |
| | Weight | 18Kg (40lb) | |

Dimensions

Unit: mm

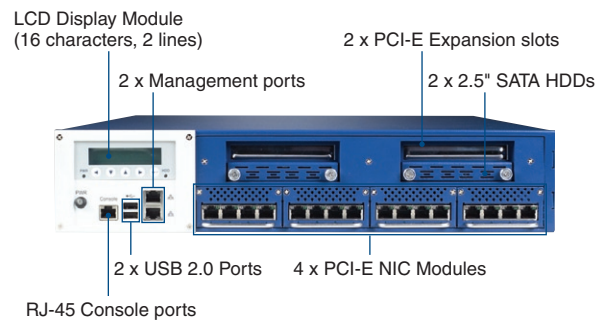
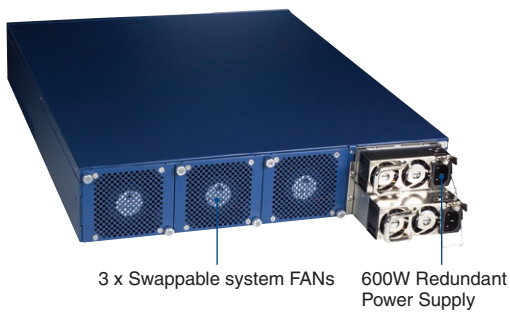
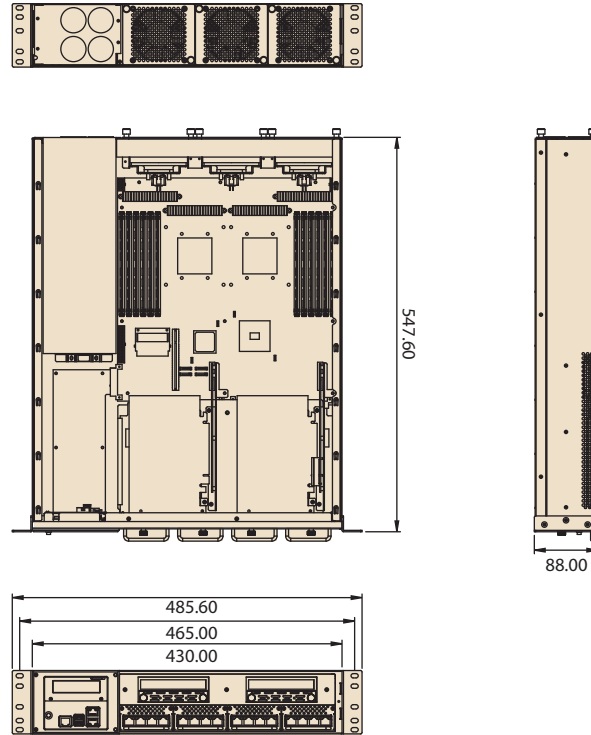

Ordering Information

| Model Number | Configuration |
|--------------|------------------------------------|
| FWA-6500CFE | 4 x NIC modules, up to 16 GE ports |
| FWA-6500BE | FWA-6500 Base system, w/o module |
| NAEM-0101 | 4-port Copper module |
| NAEM-0102 | 4-port Fiber module |
| NAEM-1001 | 2-port 10G module |

* Advantech may make changes to specifications and product descriptions at any time, without notice.