

Single Output Industrial Power Supplies

Features

- ◆ Power factor Corrected
- ◆ Wide range output adjustment
- ◆ Single wire current share
- ◆ Input transient protection
- ◆ UL508 Industrial Controls Approval
- ◆ Factory Mutual Approval (Class 1, Div 2)
- ◆ 5 Year Warranty
- ◆ EN61000-4 Input Transient

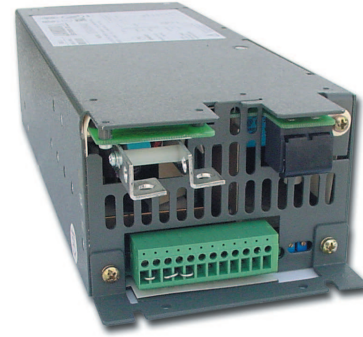

| Specifications | | JFS0500 | JFS0750 | JFS1000 | JFS1500 | JFS2000 |
|-------------------------------|-------|---|---------|---------|---------|-------------------|
| AC Input Voltage | - | 85-265VAC (170-265VAC JFS2000), 47-63Hz | | | | |
| DC Input Voltage Range | - | 120-330VDC (240-330VDC for JFS2000) | | | | |
| Input Current (typ@110VAC) | A rms | 6 | 9 | 12 | 20 | 12 ⁽¹⁾ |
| Inrush Current (110 / 220VAC) | A | 35 / 70 | | | | - / 70 |
| Efficiency (typ@110VAC) | % | 75 | | | | 82 ⁽²⁾ |
| Power Factor | - | Meets EN61000-3-2 (0.99 typical) | | | | |
| Overcurrent Protection | - | <110% (auto recovery) | | | | |
| Overvoltage Protection | V | 24V models set at 30V, 48V models set at 60V (auto recovery) | | | | |
| Hold Up Time (Typ) | ms | 16 | | | | |
| Transient Reponse | - | For 25% load change, recovers to regulation within 5ms | | | | |
| Remote Sense | - | Compenstates for 0.25V drop per leg | | | | |
| Remote Adjust | - | With either external Resistor or Voltage | | | | |
| Remote On / Off | - | Low = OFF, Open = ON | | | | |
| Signals & Indicators | - | Open Collector AC Fail and DC Good, Green LED | | | | |
| Parallel Connection | - | Single wire current share | | | | |
| Operating Temperature | °C | -20 to +70°C, derate linearly to 50% load from 50°C (30 min warm up at -20°C) | | | | |
| Storage Temperature | °C | -40 to +85 | | | | |
| Humidity (non condensing) | %RH | 10 - 90 | | | | |
| Cooling | - | Internal fan | | | | |
| Withstand Voltage | - | Input - Ground 2kVAC, Input - Output 3kVAC, Output - Ground 500VDC | | | | |
| Vibration | - | Per IEC68-2-6 | | | | |
| Shock | - | Per IEC68-2-27 | | | | |
| Safety Agency Approvals | - | UL508, UL60950, CSA22.2 No.60950, EN60950, FM3611 & CE Mark | | | | |
| Conducted & Radiated EMI | - | EN55022 Class A, FCC Docket 20780 Part 15, subpartJ, Class A | | | | |
| Weight (Net / Shipping) | lbs | 6 / 7 | 7 / 8 | | 9 / 10 | |
| Size (WxHxD) | mm | See output line drawings | | | | |
| Warranty | - | 5 years | | | | |

Notes: (Consult Installation Manual for detailed specifications, test methods and application notes)

(1) At 220VAC

(2) At 170VAC

Output Ratings

| Model | Nom. Volt. | Adjust. Range | Min Load | Max Current | Load Reg (mV) | Line Reg (mV) | Ripple & Noise (mV p-p) |
|------------|------------|---------------|----------|-------------|---------------|---------------|-------------------------|
| JFS0500-24 | 24V | 20 - 29 | 0 | 20.8 | < 240 | < 240 | 250 |
| JFS0750-24 | 24V | 20 - 29 | 0 | 31.2 | < 240 | < 240 | 250 |
| JFS1000-24 | 24V | 20 - 29 | 0 | 41.6 | < 240 | < 240 | 250 |
| JFS1500-24 | 24V | 20 - 29 | 0 | 62.5 | < 240 | < 240 | 250 |
| JFS2000-24 | 24V | 20 - 29 | 0 | 83.3 | < 240 | < 240 | 250 |
| JFS0500-48 | 48V | 36 - 56 | 0 | 10.4 | < 480 | < 480 | 500 |
| JFS0750-48 | 48V | 36 - 56 | 0 | 15.6 | < 480 | < 480 | 500 |
| JFS1000-48 | 48V | 36 - 56 | 0 | 20.8 | < 480 | < 480 | 500 |
| JFS1500-48 | 48V | 36 - 56 | 0 | 31.2 | < 480 | < 480 | 500 |
| JFS2000-48 | 48V | 36 - 56 | 0 | 41.6 | < 480 | < 480 | 500 |

JFS0750/1000 Outline Drawing

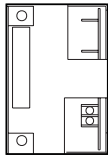

FRONT VIEW

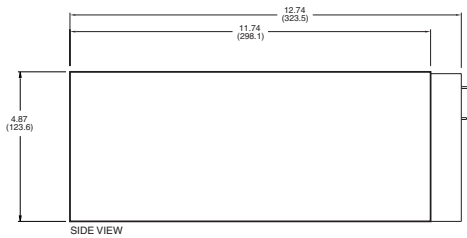

SIDE VIEW

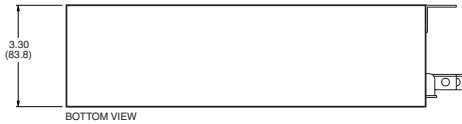

BOTTOM VIEW

NOTE:
1. DIMENSIONS ARE IN INCHES EXCEPT DIMENSIONS () ARE IN MM.
2. WEIGHT: NET 7.0 LBS, SHIPPING 8.0 LBS.

Other Industrial Products

| | |
|---------------|-----------------------------------|
| HWS | 15W to 1500W Single Output |
| LZS, LZSa | 250W to 1500W Single Output |
| DLP, DPP, DSP | 10 to 480W DIN Rail Single Output |

For Additional Information, please visit
us.tdk-lambda.com/lp/products/jfs-series.htm



JFS0500 Outline Drawing

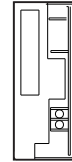

FRONT VIEW

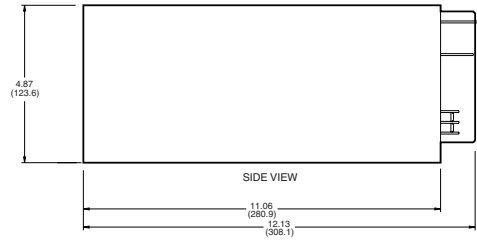

SIDE VIEW

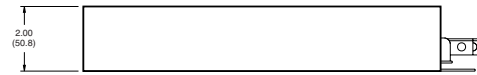

NOTE:
1. DIMENSIONS ARE IN INCHES EXCEPT DIMENSIONS () ARE IN MM.
2. WEIGHT: NET 6.0 LBS, SHIPPING 7.0 LBS.

PRELIMINARY

JFS1500/2000 Outline Drawing

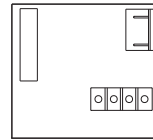

FRONT VIEW

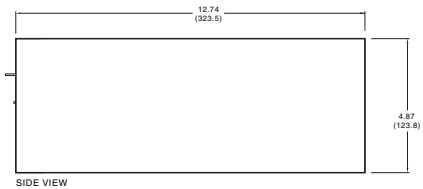

SIDE VIEW

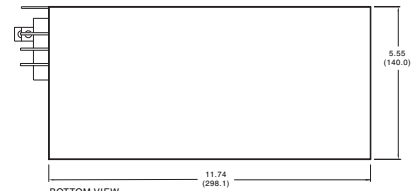

BOTTOM VIEW

NOTE:
1. DIMENSIONS ARE IN INCHES EXCEPT DIMENSIONS () ARE IN MM.
2. WEIGHT: NET 9.0 LBS, SHIPPING 10.0 LBS.